

"LEMSCO" SERIES MEDIUM DUTY J-LEG PANELS

The 2W "Lemsko" Series Medium Duty J-Leg Panels are a medium weight, postless panel that is designed primarily for perimeter panel applications in wet or soft ground conditions. These panels are a popular choice of panel due to their wide range of uses which include pens, round pens, property fencing, and other medium stress cattle handling applications. These panels feature a "J-Leg" which helps to combat the panel sinking into the ground.

Made from 14 Gauge - 1½" Diameter Round Steel Tube that is laser saddle cut and robotically welded - these medium duty panels utilize the same manufacturing practices as 2W's "400, 500, 600" Series Heavy Duty products. These panels are powder coated in 2W's standard **Dark Gray**.

POSTLESS "LEMSCO"
CONNECTING SYSTEM



MEDIUM DUTY
14 GAUGE TUBE



J-LEG STABILITY
SUPPORT LEG

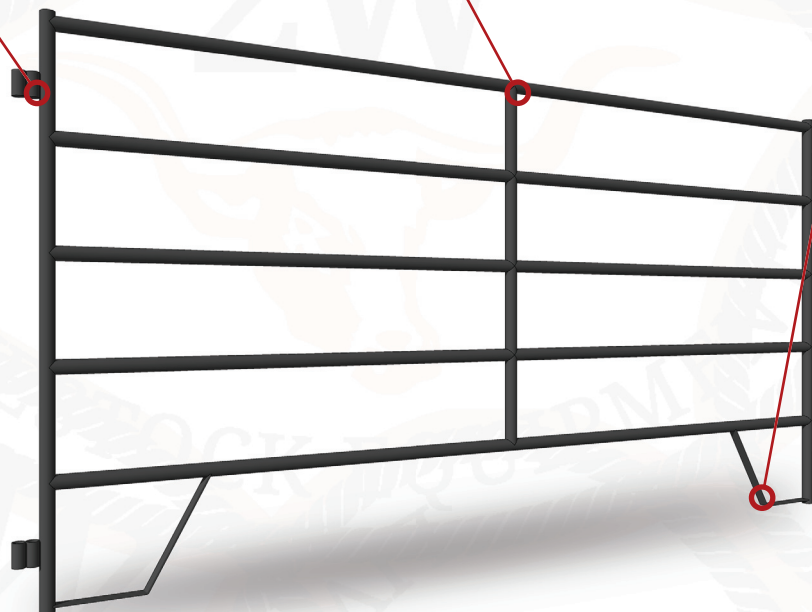

MATERIAL SPECIFICATIONS

14 GAUGE - 1½" DIA.
ROUND STEEL TUBE

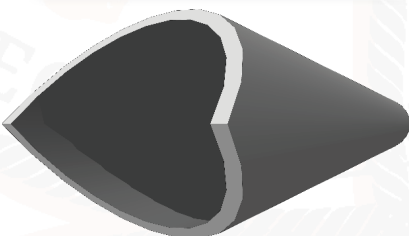

1¾" X 3/16" THICK
FLAT BAR

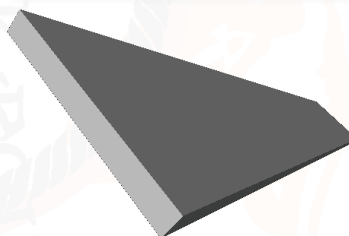

TECHNICAL SPECIFICATIONS



SPECIFICATIONS

"Lemsco" Series Medium Duty J-Leg Panels

14 Gauge - 1½" Dia. Round Steel Tube | Postless Connecting System | J-Leg Stability Supports | Robotic Welded Seams

"Lemsco" Series Medium Duty J-Leg Panels

Unit Number	Description	Length (ft)		Width (in)		Assemb. Height (in)		Weight (lbs)	
3450	"Lemsco" Series J-Leg Panel (5 Rail)	10	ft	1.5	in	60	in	84	lbs
3451	"Lemsco" Series J-Leg Panel (5 Rail)	12	ft	1.5	in	60	in	102	lbs
3452	"Lemsco" Series J-Leg Panel (5 Rail)	16	ft	1.5	in	60	in	129	lbs

Manufactured in Canada  2Wequipment.com



2W Livestock Equipment is a locally owned livestock handling equipment manufacturing company based in Nanton, Alberta, located 80 kilometers south of Calgary in the heart of cattle country. Being the largest local employer 2W highly values, supports, and participates in local community programs and events.

 /2WEquipment

 @2WEquipment

 @2WEquipment

CONTACT YOUR LOCAL DEALER:

MAIL TO: