

# CONTINUOUS FENCE PANELS AND RAILS

2W's popular **Continuous Fence Panels & Rails** offer property owners a durable, cost effective, and easy to install solution to property fencing. The **Continuous Fence Panels** come standard in 20 foot lengths, 4 foot high, with five vertical crossmember reinforcement rails per panel. The ends of the panels come "Swedged" so that each panel easily connects to one another. **End caps, 145 degree round corners, and 90 degree corners** are available as well with **mounting brackets** that allow fixing panels to wooden or metal posts. **These panels come standard unpainted, but paint options are available.**

The 2W Continuous Fence is a **practical, simple, long lasting, and cost effective** solution for large scale livestock or general property fencing applications.

EASY TO CONNECT  
SWEDGED ENDS



CROSS MEMBER  
REINFORCEMENTS



EASY TO MOUNT  
TO FENCE



ROBOTIC WELDED  
CONNECTIONS

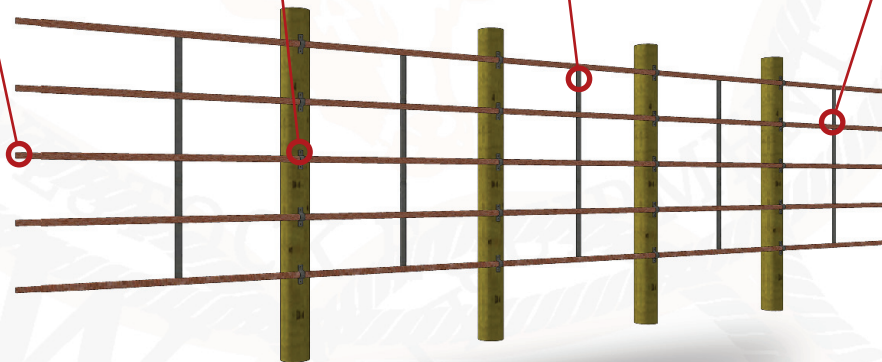

## MATERIAL SPECIFICATIONS

13 GAUGE - 2" DIA.  
ROUND STEEL TUBE

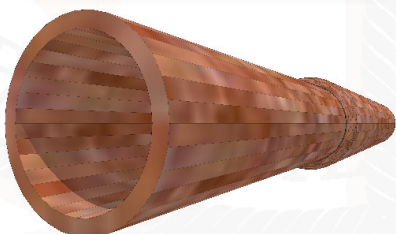

1 1/4" X 1 1/4"  
FLAT BAR

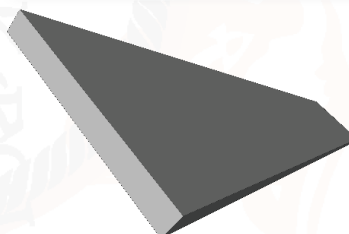

# TECHNICAL SPECIFICATIONS

## SPECIFICATIONS

### Continuous Fence Panel

14 Gauge - 1¼" Round Steel Tubing | 1¼" x 1¼" Vertical Flat Bar Every 4 Feet | 4 Feet Tall With 5 Rails Across | Swedged Ends

**IMPORTANT NOTE:** Continuous Fence Panels come standard **unpainted**, paint options are available upon request.

Continuous Fence Panels & Rails - Panels						
Unit Number	Description	Length (ft)	Width (in)	Height (in)	Weight (lbs)	
4600	Continuous Fence Panel	20	ft	1.25	in	129 lbs

### Continuous Fence Rail

13 Gauge - 2" Diameter Round Steel Tubing | 4 Feet Tall With 5 Rails Across | Single sided wedged Ends

**IMPORTANT NOTE:** Continuous Fence Panels come standard **unpainted**, paint options are available upon request.

Continuous Fence Panels & Rails - Rail						
Unit Number	Description	Length (ft)	Width (in)	Height (in)	Weight (lbs)	
5020	Continuous Fence Rail	23	ft	2	in	44 lbs

Continuous Fence Panels & Rails - Misc.						
Unit Number	Description	Length (ft)	Width (in)	Height (in)	Weight (lbs)	
4602	Continuous Fence Panel Corner (90°)	N/A	ft	N/A	in	12 lbs
4605	Continuous Fence Panel Rounded Corner	N/A	ft	N/A	in	11 lbs
4601	Continuous Fence Panel Clamp	N/A	ft	N/A	in	1 lbs
4603	Continuous Fence Panel End Cap	N/A	ft	N/A	in	8 lbs

Manufactured in Canada  2Wequipment.com



2W Livestock Equipment is a locally owned livestock handling equipment manufacturing company based in Nanton, Alberta, located 80 kilometers south of Calgary in the heart of cattle country. Being the largest local employer 2W highly values, supports, and participates in local community programs and events.

 /2WEquipment

 @2WEquipment

 @2WEquipment

CONTACT YOUR LOCAL DEALER:

MAIL TO: